

MODEL : DW-40S [Screw end Double Window Sight Glass]

Connection : Screw BSPT, NPT



(DN15 – DN25)

DESCRIPTION

For monitoring the right operation of a steam trap to avoid leakage of live steam and consequently big energy losses, a sight glass is recommended to be installed downstream of the steam trap.

Double window DW sight glass, has been designed for this particular application.

Connections are female screwed or flanged.



- USE: Condensate pipes downstream steam traps.
- AVAILABLE MODELS: DW 40 S
- SIZES: DN ½" to DN 1"; DN 15 to DN 25
- CONNECTIONS: Female screwed ISO 7/1Rp(BS21), NPT (ANSI B1.20.1) Flanged EN 1092-1 or ANSI
- INSTALLATION: Horizontal or vertical installation. See IMI, installation and maintenance instructions.

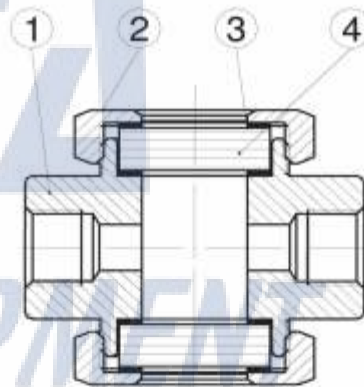

PMO – Max. operating pressure 40 bar
 TMO – Max. operating temperature 280 °C
 How to order: i.e. DW40 DN ½" BSP.

DIMENSIONS (mm)-Screwed					EN 1092-1 Flanges	
SIZE DN	A	B	C	WGT. Kgs	E	WGT. Kgs
15	90	80	60	1,25	130	2,8
20	90	80	60	1,25	150	3,4
25	100	87	65	2,1	160	4,7

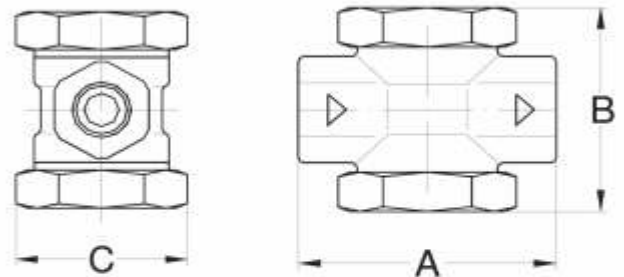

MATERIALS		
POS.Nr.	DESIGNATION	MATERIAL
1	Body	P250GH / 1.0460
2	Glass nut	P250GH / 1.0460
3	* Gasket	St.Steel / Graphite
4	* Window glass	Borosilicate

*Available spare parts.

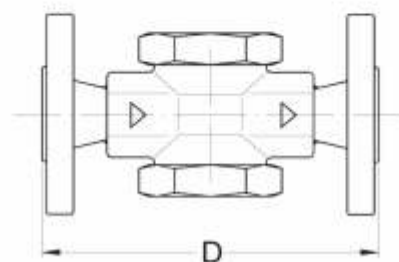

Specification is subject to change without prior notice