

MODEL : BV-10 [General Butterfly Valve]

Connection : Universal, Wafer JIS 10K, PN 16, ANSI 150

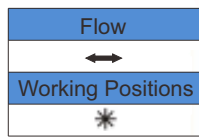

DIMENSIONS

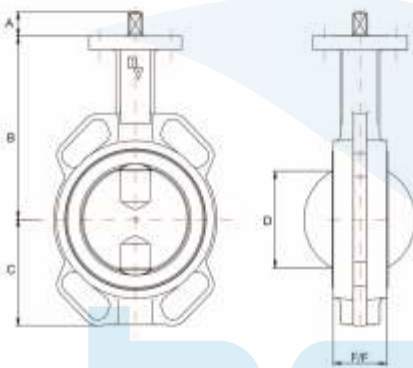

DN	NPS	BV10					BV10-NP				
		A	B	C	D	F/F	A	B	C	D	F/F
32	1 1/4	22,0	110,0	52,0	[*]	33,0	U/R	U/R	U/R	U/R	U/R
40	1 1/2	22,0	110,0	89,0	29,0	33,0	U/R	U/R	U/R	U/R	U/R
50	2	22,0	142,7	71,4	30,0	43,0	22,0	141,0	64,0	30,0	43,0
65	2 1/2	22,0	155,4	77,8	45,0	46,0	22,0	153,0	71,0	45,0	46,0
80	3	22,0	161,8	89,0	64,0	46,0	22,0	157,0	94,0	64,0	46,0
100	4	22,0	178,0	102,0	90,0	52,0	22,0	176,0	108,5	90,0	52,0
125	5	22,0	190,5	123,0	110,0	56,0	22,0	191,0	120,0	110,0	56,0
150	6	22,0	205,2	138,0	146,0	56,0	22,0	202,0	135,0	146,0	56,0
200	8	34,5	237,0	168,0	194,0	60,0	34,5	243,5	165,2	194,0	60,0
250	10	34,5	268,3	207,0	242,0	68,0	34,5	273,0	202,0	242,0	68,0
300	12	34,5	308,5	243,5	292,0	78,0	34,5	311,0	235,0	292,0	78,0

Dimensions in mm ; U/R = Upon Request
 [*] For this size, the open disc dimension is covered by F/F

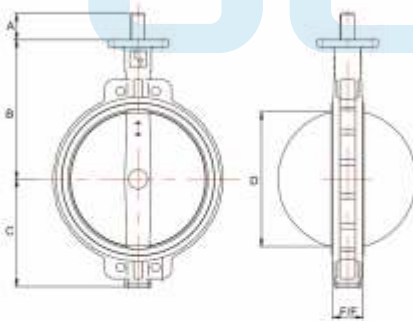

DN	NPS	BV10				
		A	B	C	D	F/F
350	14	65,0	368,0	259,0	325,0	78,0
400	16	75,0	400,0	309,0	377,0	102,0
450	18	75,0	422,0	327,0	426,0	114,0
500	20	90,0	480,0	363,0	475,0	127,0

Dimensions in mm

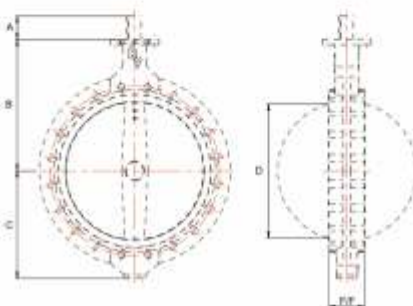

DN	NPS	BV10				
		A	B	C	D	F/F
600	24	100,0	562,0	459,0	572,0	154,0
700	28	85,0	626,0	518,0	674,0	165,0
800	32	100,0	666,0	605,0	772,0	190,0
900	36	118,0	722,0	655,0	840,0	203,0
1000	40	140,0	806,0	713,0	940,0	216,0
1200	48	150,0	938,0	855,0	1132,0	254,0

Dimensions in mm

Specification is subject to change without prior notice

BV10-2366x-LE 050-300



TECHNICAL DESCRIPTION

- Wafer type butterfly valve with lever
- Design according to EN 593 fig. 3a body type
- Testing acc. to EN12266-1(P10-P12)/MSS SP-67 type 1
- Max. working pressure : 16 bar/ 250 psi
- Shell(body) test pressure : 24bar/375 psi
- Seat test pressure : 17,6 bar/250psi
- Max. temperature : dependent of the seat, see table below
- Tightness : bi-directional bubble tight acc. EN 12266-1 A.5 Rate A (formerly known as DIN 3230)
- Suitable for mounting between flanges EN1092-B1 PN6/10/16 (DIN 2632/2633 Form C) and ASME B16.5 150lbs RF.
- Face to face dimensions acc. EN 558-1 table 1 series 20 (DIN 3202 K1) and API 609 category A
- Body coating : Epoxy powder coating 150 μm to 250 μm , blue RAL 5015

Suitable for :		Not recommendable for :	Temperature range :
EPDM : Ethylen-Propylene Diene Monomer (or Terpolymer)	water/steam, sea water, brine, esters, ketone, alkalis, caustic soda	hydrocarbons, oils, fats	-15°C to 120°C
EPDM-HT : EPDM High Temperature	water/steam, sea water, brine, esters, ketone, alkalis, caustic soda	hydrocarbons, oils, fats	-15°C to 130°C
NBR : Acrylonitrile-Butadiene copolymer	hydrocarbons, oils, greases, gas oil	solvents, benzene, xylol	-10°C to 80°C
PTFE* : PolyTetraFluoroEthylene	solvents, corrosive products	fluid containing powders, alkaline metals, gaseous fluorines	-10°C to 120°C
VQM/MVQ* : Methyl-Vinyl Siloxane	food & beverages	steam, oils, hydrocarbons	-60°C to 180°C
FKM : fluorocarbon polymer	mineral oils and greases, hydrocarbons, petrol, diesel fuels	steam, Freon, alkalis, ketones, organic acids	-20°C to 160°C

*Max. working pressure : 10 bar, seat test pressure : 11 bar

KV-VALUES

SIZE		Flow in m ³ /h @ r p 1 bar								
		CLOSE -----> OPEN								
NPS	DN	10°	20°	30°	40°	50°	60°	70°	80°	90°
2	50	0,1	3	6	13	23	38	60	90	99
2 1/2	65	0,1	5	10	22	39	65	102	153	169
3	80	0,2	8	15	34	60	100	157	237	260
4	100	0,3	15	31	67	120	198	313	470	516
5	125	0,4	25	52	114	204	337	533	800	879
6	150	0,7	39	82	176	315	520	824	1236	1358
8	200	2	77	162	351	625	1034	1637	2454	2697
10	250	3	130	275	597	1064	1760	2786	4179	4592
12	300	3	201	426	922	1643	2719	4304	6456	7095

Cv = 1,16 * Kv



Industriepark Mechelen Noord 1 | Blokhuisstraat 24 | 2800 Mechelen | Belgium
tel. +32/(0)15 29 40 70 | fax +32 (0) 15 20 14 13 | info@belven.com | www.belven.com

Specification is subject to change without prior notice

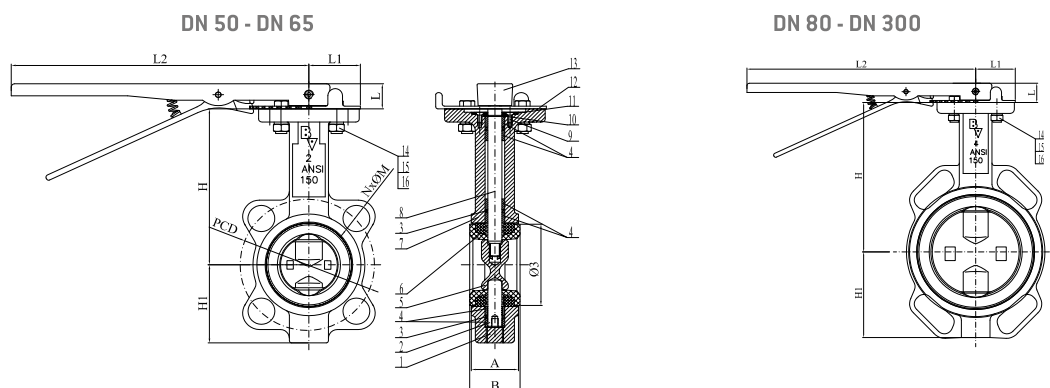

DN	SIZE	L	L1	L2	H	H1	A	B	Ø3	PCD	N-ØM	Weight(kg)
50	2"	22	46	266	142,7	71,4	43	47	Ø73,3	Ø120	4-Ø24	3,5
65	2 1/2"	22	46	266	155,4	71,4	46	49	Ø86	Ø138,75	4-Ø24	4,25
80	3"	22	46	266	161,8	89,0	46	49	Ø100,3	--	--	4,3
100	4"	22	46	266	178,0	102,0	52	55	Ø132	--	--	5,6
125	5"	22	46	266	190,5	123,0	56	59	Ø156	--	--	7,1
150	6"	22	46	266	205,2	138,0	56	59	Ø185,4	--	--	7,2
200	8"	34,5	75	356	237,0	168,0	60	64	Ø235,2	--	--	12,9
250	10"	34,5	75	356	268,3	207,0	68	72	Ø289,4	--	--	22
300	12"	34,5	75	356	308,5	243,5	78	82	Ø341,2	--	--	36,5

ITEM	NAME	QTY	2366 E	2366 EHT	2366 B	2366 T	2366 S	2366 V
1	SCREW PLUG	1	ZINC PLTD STEEL	ZINC PLTD STEEL	ZINC PLTD STEEL	ZINC PLTD STEEL	ZINC PLTD STEEL	ZINC PLTD STEEL
2	BOTOM SHAFT	1	SS416	SS416	SS416	SS416	SS416	SS416
3	O-RING	3	EPDM	EPDM HT	NBR	FKM	SILICONE	FKM
4	BUSHING	6	PTFE/Nylon	PTFE/Nylon	PTFE/Nylon	PTFE/Nylon	PTFE/Nylon	PTFE/Nylon
5	DISC	1	CF8M	CF8M	CF8M	CF8M	CF8M	CF8M
6	SEAT	1	EPDM	EPDM HT	NBR	PTFE	SILICONE	FKM
7	BODY	1	GG25	GG25	GG25	GG25	GG25	GG25
8	TOP SHAFT	1	SS416	SS416	SS416	SS416	SS416	SS416
9	PHILIP SCREW	2	ZINC PLTD STEEL	ZINC PLTD STEEL	ZINC PLTD STEEL	ZINC PLTD STEEL	ZINC PLTD STEEL	ZINC PLTD STEEL
10	CIRCLIP	1	65 Mn	65 Mn	65 Mn	65 Mn	65 Mn	65 Mn
11	PLATE	1	STEEL	STEEL	STEEL	STEEL	STEEL	STEEL
12	NOTCH PLATE	1	STEEL	STEEL	STEEL	STEEL	STEEL	STEEL
13	LEVER	1	MALLEABLE IRON	MALLEABLE IRON	MALLEABLE IRON	MALLEABLE IRON	MALLEABLE IRON	MALLEABLE IRON
14	BOLT	2	ZINC PLTD STEEL	ZINC PLTD STEEL	ZINC PLTD STEEL	ZINC PLTD STEEL	ZINC PLTD STEEL	ZINC PLTD STEEL
15	SPRING WASHER	2	ZINC PLTD STEEL	ZINC PLTD STEEL	ZINC PLTD STEEL	ZINC PLTD STEEL	ZINC PLTD STEEL	ZINC PLTD STEEL
16	NUT	2	ZINC PLTD STEEL	ZINC PLTD STEEL	ZINC PLTD STEEL	ZINC PLTD STEEL	ZINC PLTD STEEL	ZINC PLTD STEEL



Industriepark Mechelen Noord 1 | Blokhuisstraat 24 | 2800 Mechelen | Belgium
 tel. +32/(0)15 29 40 70 | fax +32 (0) 15 20 14 13 | info@belven.com | www.belven.com

Specification is subject to change without prior notice

BV10-2366x-GB 200-300

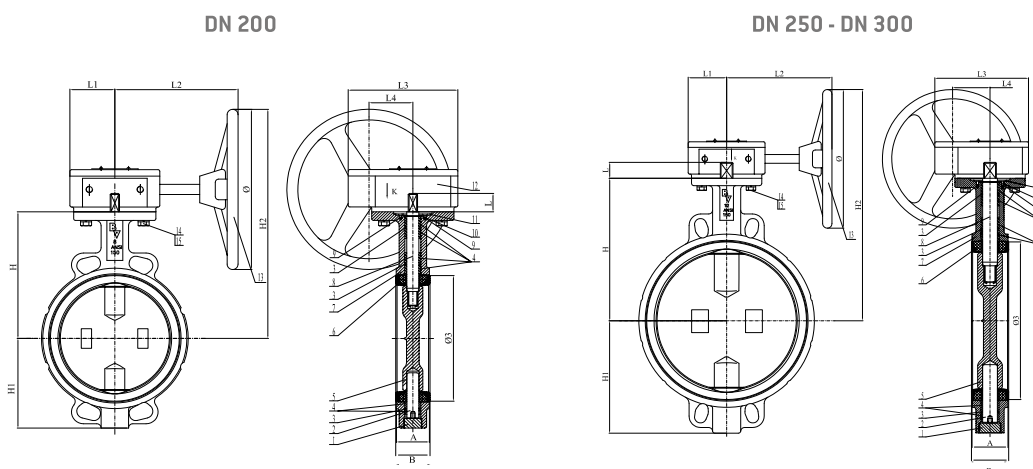

DN	SIZE	L	L1	L2	L3	L4	Ø	H	H1	H2	A	B	Ø3	Weight(kg)
200	8"	34,5	76	237	179	63	300	237,0	168,0	433,0	60	64,5	Ø235,2	24,9
250	10"	34,5	76	237	179	63	300	268,3	207,0	464,3	67	72	Ø289,4	32
300	12"	34,5	82	225	200	78	341,2	308,5	243,5	504,5	76	81	Ø341,2	50,5

ITEM	NAME	QTY	2366 E	2366 EHT	2366 B	2366 T	2366 S	2366 V
1	SCREW PLUG	1	ZINC PLTD STEEL	ZINC PLTD STEEL	ZINC PLTD STEEL	ZINC PLTD STEEL	ZINC PLTD STEEL	ZINC PLTD STEEL
2	BOTOM SHAFT	1	SS416	SS416	SS416	SS416	SS416	SS416
3	O-RING	3	EPDM	EPDM HT	NBR	FKM	SILICONE	FKM
4	BUSHING	6	PTFE/Nylon	PTFE/Nylon	PTFE/Nylon	PTFE/Nylon	PTFE/Nylon	PTFE/Nylon
5	DISC	1	CF8M	CF8M	CF8M	CF8M	CF8M	CF8M
6	SEAT	1	EPDM	EPDM HT	NBR	PTFE	SILICONE	FKM
7	BODY	1	GG25	GG25	GG25	GG25	GG25	GG25
8	TOP SHAFT	1	SS416	SS416	SS416	SS416	SS416	SS416
9	PHILIP SCREW	2	ZINC PLTD STEEL	ZINC PLTD STEEL	ZINC PLTD STEEL	ZINC PLTD STEEL	ZINC PLTD STEEL	ZINC PLTD STEEL
10	CIRCLIP	1	65 Mn	65 Mn	65 Mn	65 Mn	65 Mn	65 Mn
11	PLATE	1	STEEL	STEEL	STEEL	STEEL	STEEL	STEEL
12	GEARBOX	1	GG25	GG25	GG25	GG25	GG25	GG25
13	HANDWHEEL	1	GG25	GG25	GG25	GG25	GG25	GG25
14	BOLT	4	ZINC PLTD STEEL	ZINC PLTD STEEL	ZINC PLTD STEEL	ZINC PLTD STEEL	ZINC PLTD STEEL	ZINC PLTD STEEL
15	SPRING WASHER	4	ZINC PLTD STEEL	ZINC PLTD STEEL	ZINC PLTD STEEL	ZINC PLTD STEEL	ZINC PLTD STEEL	ZINC PLTD STEEL

Industriepark Mechelen Noord 1 | Blokhuisstraat 24 | 2800 Mechelen | Belgium
 tel. +32/(0)15 29 40 70 | fax +32 (0) 15 20 14 13 | info@belven.com | www.belven.com



Specification is subject to change without prior notice